

Gerrish Township

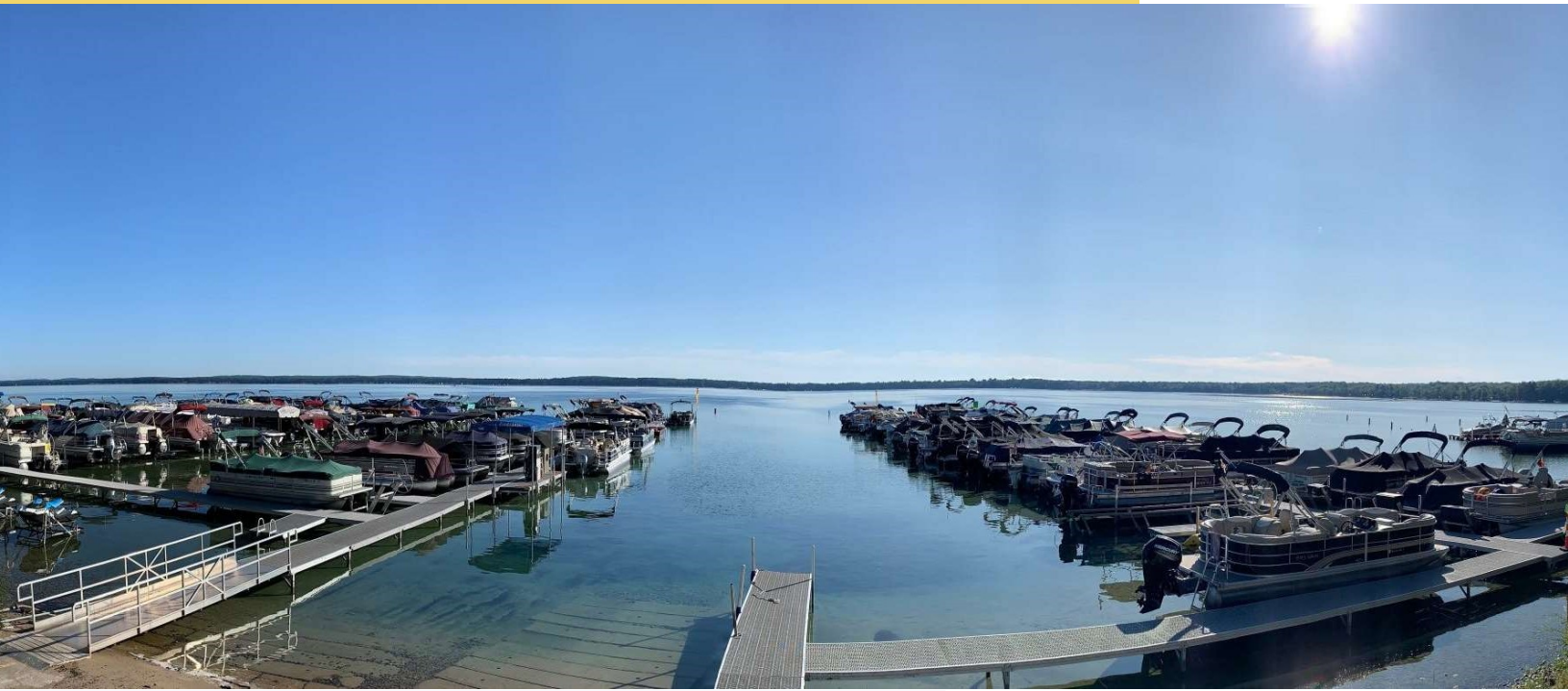

Parks and Recreation Master Plan 2020-2024

(989)821-9313
Roscommon, MI

www.gerrishtownship.org

Gerrish Township Roscommon, MI

5-Year Recreation Plan 2020-2024

Gerrish Township Board

David Udy, Supervisor
Kathleen Patchin, Clerk
Leasa Tulgetske, Treasurer
Jim Lippert, Trustee
Mary Link, Trustee

Parks and Recreation Advisory Committee

Kelly Kirkpatrick
Dave Reynolds
Mike Purkey
Gerald Wall
Leasa Tulgetske
David Udy

Consultant

Lisa Leedy, Alliance for Economic Success

Community Description

INTRODUCTION

Gerrish Township is reliant on its natural resources, the principal of which being beautiful Higgins Lake, to attract both residents and visitors. The preservation of our Township's open spaces and the development and safeguarding of our recreational areas and parks is vital not only to the health and wellbeing of our residents but to our economy as well. Gerrish Township is committed to preserving our natural resources through exceptional stewardship and continued dedication to natural parks and recreation areas.



REGIONAL SETTING

Gerrish Township is located in the center of Northern Michigan's Lower Peninsula in the northwest portion of Roscommon County. Gerrish Township can easily be accessed by two major expressways, US 127 and I-75. Gerrish Township encompasses 37.2 square miles, of which 27.6 square miles is land. It is a rural community with over 6,000 acres of wooded State owned lands. Higgins Lake, the State's 10th largest and 5th deepest inland lake, is located largely within the bound.



POPULATION AND DEMOGRAPHICS

The population of Gerrish Township is fluid. Though the 2010 U.S. Census shows 2,977 permanent residents, Gerrish Township also hosts over 2,000 seasonal residents. These residents own second homes within our community and regularly spend weekends and vacations in our area. These non-homesteaded property owners play an important role in our need for improvements to existing parks and recreation areas as well as the creation of new recreational opportunities.

Gerrish Township is also visited by approximately 30,000 tourists each year, the majority of which visit during the summer months. This transient population provides a significant contribution to the commercial enterprises of the area. These visitors must be considered when evaluating the recreational needs of our community. The increase to our population of roughly 600 percent drastically increases the usage of our current parks, recreation areas and lake access points.

COMMUNITY COMPOSITION

The most recent U.S. Census results show 30.7 percent of the year round population over the age of 65. Retirees are drawn to this area by lower cost housing, less stressful living, and attractive recreational opportunities. This figure does not, however, account for the ages of our transient population or the average age of our visitors. Our access to Higgins Lake and abundance of State lands make us a destination for families and individuals of all ages.



Age	% of township population
Under 5 years	1.70%
5 to 9 years	3.90%
10 to 14 years	2.70%
15 to 19 years	5.90%
20 to 24 years	0.30%
25 to 34 years	5.40%
35 to 44 years	7.90%
45 to 54 years	9.00%
55 to 59 years	9.70%
60 to 64 years	14.60%
65 to 74 years	24.50%
75 to 84 years	10.00%
85 years and over	4.40%
Median age (years)	61.1

2017 American Community Survey

Our community also includes both the Roscommon Area Public Schools (R.A.P.S.) and the C.O.O.R. Intermediate School District. R.A.P.S. facilities within our Township include a high school, middle school and elementary school. C.O.O.R. ISD, which serves six local public school districts, provides special education, career and technical education, information technology and general education programs. C.O.O.R.'s main campus is located solely in Gerrish Township. The location of these two public education institutes brings a larger influx of young adults and children to our community.

The overall composition of our community, which is made up of a much larger demographic than our Census data reflects, greatly influences the use and design of our recreational areas. Gerrish Township strives to reflect the average age of our permanent population and the needs of our businesses and visitors in our Recreation Plan.

Administrative Structure

MANAGEMENT AND OVERSIGHT

The Gerrish Township Board of Trustees currently serves as the Parks and Recreation Board. The Gerrish Township Board is comprised of five (5) elected officials that represent the public interest. The Board, as enabled under Public Act 157 of 1905, is entrusted with development, oversight, control of expenditures and activity planning for our parks and recreations.

Decisions for day to day management and improvements are made based on public need and input. Input for decision making in regards to improvements and expansion are done on a project by project basis. For example, a Gerrish Township Park Advisory Committee was established in May 2010 to submit a plan of action for the Board to consider in improving the Gerrish Township Park.

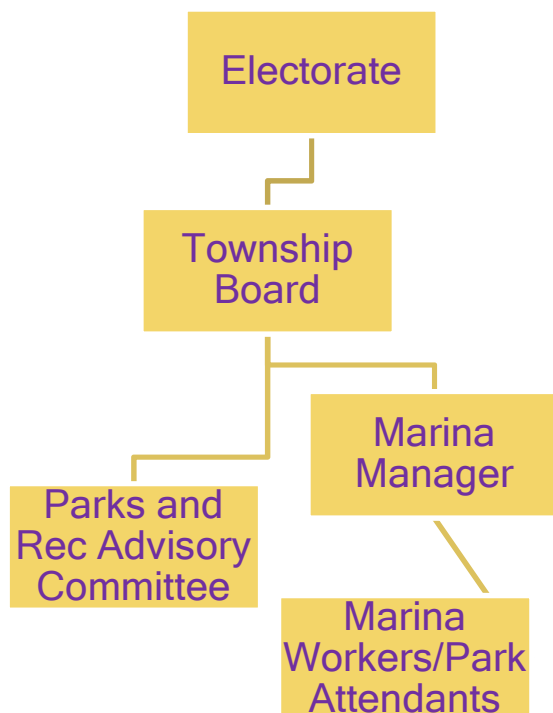

Current staff of our parks and recreation department includes the Marina Manager, who was hired in 2019 and currently acts as our Parks and Recreation Manager. Main duties include day-to-day management and planning at our facilities, oversight of nine (9) seasonal employees and their work in the Parks Department. These employees work at our Community Park Marina and Gerrish Township Parks providing daily maintenance and customer service.

PARTNERSHIPS

Our Township actively builds partnerships within our community by utilizing local businesses as partners in our park and recreation endeavors. R.O.O.C. Inc, which offers Adult Day Services that allow for work experience and community involvement, currently works in various areas of our Township. We are also actively supporting the creation of the Higgins Lake Trailway, a Rotary Club and the Roscommon County Community Foundation joint endeavor that will create a walking/biking path around Higgins Lake.

We willingly accept volunteer donations of time, funds and materials for case by case projects within our existing parks and recreation areas. Our ACT-NOW Community Policing Group, comprised solely of volunteer residents, willingly assist the community with a variety of recreational events & projects such as the Sunrise Run, Trailway Project and Adopt a Road. It is within the scope of our five year plan to develop an Adopt a Park program that would allow residents to participate in beatification and upkeep of our facilities and green spaces.



GRANT

AWARDS

Gerrish Township has been awarded the following grants:

Michigan Natural Trust Fund Grants: Gerrish Township received two



\$1,400,000.00 acquisition grants, TF07-002 and TF06-036, for phases I and II of purchase and improvements to the then proposed Gerrish Township Community Park Marina located on the southwest side of Higgins Lake. The Gerrish Township Community Park is approximately 5.13 acres of lakefront property with 427 feet of frontage. Purchase of the park was completed in 2009.



Land and Water Conservation Fund Grant 2010: 50% matching grant for \$30,000.00 for universally accessible restroom facilities at the Gerrish Township Community Park Marina.



Roscommon County Community Foundation 2013:

In 2013, Gerrish Township Park on Carlos Ave. received updated playground equipment which is constructed for children with all ability levels and includes universal accessibility for all youth. In addition the restroom and the path leading to it, received an upgrade to universal accessibility as well.



Rotary Club of Roscommon Grant 2016: A \$40,000.00 grant from Rotary allowed the township to purchase the playground equipment and structure at the Municipal Park behind the township building.

BUDGET AND FINANCING



The current Gerrish Township budget for parks and recreation is divided between two fund accounts, the Community Park Marina fund and the Parks and Recreation fund. Our Parks and Recreation fund, which is funded solely through our General Fund revenues, is roughly 2 percent of our general fund budget. It encompasses the Gerrish Township Park, walking path, Municipal Park, tennis courts and undeveloped locations. The 2019-2020 budget is \$20,230. Current expenses include two seasonal, part time park attendants, grounds maintenance and improvements to the tennis courts and updates to the Gerrish Township Park.

Our Community Park Marina is maintained as a separate fund account. It is currently a self-sufficient recreational area that receives no general fund monies. The Community Park Marina fund was established in April 2009 in anticipation of purchasing the Higgins Lake Boat Yard. The initial revenues of \$3,835,573.47 included a MNRTF grant award of \$2,065,000.00 and a Township bond of \$1,500,000.00. A majority of the grant and bond were utilized in the purchase of this lake front property for a sales price of \$2,950,000.00. Remaining grant and bond monies were used for site preparations and dock purchases. Our current budget for fiscal year 2019- 2020 anticipates \$365,500.00 in revenues and \$297,171.97 in expenses.

While Gerrish Township does not currently offer any organized recreational activities, there

are several annual events and recreational opportunities throughout the Township. The Coast Guard Auxiliary, promote recreational opportunities through programs such as Boater Safety, ORV Safety, and Snowmobile Safety classes that are held at the Community Park Marina. ACT NOW also assists in encouraging recreation with annual events such as Trunk or Treat, Annual Golf Outing, Bowling Tournament Fundraisers and the Sunrise Run.

Programs	Sponsor
Farmer's Market	Gerrish Township
Safety Classes	DNR, Coast Guard, Pioneer Hills Marine
Trunk or Treat	ACT NOW
Harvest Fest & Camping	South Higgins Lake State Park
Law Enforcement Torch Run for Special Olympics of Michigan	ACT NOW
Winterfest	Higgins Lake-Roscommon Chamber of Commerce
Free Cross Country Ski Lessons	Cross Country Ski Headquarters
Watercraft Rentals	South State Park Store
Sunrise Run	Rotary Club of Roscommon



BUDGET 2019-2020

PARKS

- Township Park
- Carlos Park
- Marina

DESCRIPTION	REVENUE	EXPENSES
Community Marina Account #410	\$365,500.00*	\$297,171.97
Parks & Recreation Account #208	\$20,230.00*	\$24,109.00
Total Parks and Recreation Budget:	\$385,730.00*	\$321,280.97

***Total revenues do not include fund balance.**



PARKS AND RECREATION AREAS

INVENTORY AND EVALUATION PROCESS

The review and verification of our local parks and recreation sites was done in conjunction with the Gerrish Township Police Department's routine patrols. Each sight was evaluated based on current facilities, barrier free access standards and public accessibility. Gerrish Township also maintains up to date files of each Township owned parcel that includes legal descriptions and purchase/procurement history. Non-Township owned properties were verified in the same manner.



EXISTING PARKS AND RECREATIONAL FACILITIES

Barrier Free Accessibility: The Gerrish Township Parks and Recreation facilities have been reviewed for ease of access routes, accessibility of facilities and usage of parks and recreation equipment and structures. The ranking used for each location is categorized as required through the Department of Natural Resources Grant Management Division. A rating of '1' indicates that none of the facilities/park area meet accessibility guidelines while a top rating of '5' indicates the entire park was developed or renovated using the principals of universal design. Gerrish Township recognizes the current deficiencies in our existing parks and recreation facilities and strives to improve in this area. We are committed to renovating and creating our parks and recreation area with usage by all residents and visitors as a core design theme.

Township Owned Properties

Gerrish Township currently owns three locations that are dedicated exclusively to parks, recreation and open spaces.

Name and Location	Classification and Compliance	Site Size	Description
Gerrish Township Park 109 Carlos Avenue *MAP A	Neighborhood *2	>1 acre	Lakefront park with approximately 400 ft of public beach that offers public swim access, gazebo, picnic areas, grills, restrooms with bath house, children's play equipment, volleyball net, universally accessible boardwalk, tetherball and paved parking.
Community Park Marina 103 Mill Road *MAP C	Community Park *2	>5 acres	Lakefront park area that currently operates a 133 slip marina facility. Offers rec gas sales, fishing, grills, boating, playground and ATV safety classes and lake access. Winter activities include ice fishing and ice skating.
Gerrish Municipal Park and East Walking Trail 2997 E. Higgins Lake Drive *MAP B	Community Park *2	40 acres	Pavilion, picnic tables, grills, restroom facilities inside Township Hall, tennis courts, children's play equipment, playfields, basketball court and paved parking. Located behind the Police station, the walking trail offers two ½ mile loops of natural pathways through wooded area.

** Facilities/park areas are rated on a scale of 1 - 5 based on ADA accessibility guidelines. A top rating of '5' indicates the entire park was developed or renovated using the principals of universal design while a "1" indicates minimal ADA accessibility.*



Public Owned Facilities

Gerrish Township hosts a variety of recreational and park properties that are dedicated to public use. These include properties owned by both the State of Michigan and other local government entities.

Name and Location	Classification	Site Size	Description
Kelly Beach Eastside of Township	Neighborhood	1 acre	Beach area that is actually the roadway of Grosbeak Avenue. Owned by Roscommon County Road Commission. Hosts a swimming area and association maintained boat launch. No parking within two blocks.
South Higgins Lake State Park 106 State Park Dr.	Special Use	300 acres	Owned and operated by the State of Michigan with 1 mile of shoreline. 400 wooded campsites, a mini-cabin, dog beach, fishing, boat launch, picnic area. Nature trail for hiking. Rowboat, canoe, paddleboat, small motorboat and pontoon rentals. Ice fishing. Metal detecting area and park store.
DNR Cross Country Ski Trails XC Ski HQ 9435 N. Cut Rd.	Park Trail	< 10 acres	Offers over 10 miles of groomed cross country ski trails that are available as walking paths in the summer. Maintained by privately owned facility, Cross Country Ski Headquarters.
Marl Lake E. Higgins Lake Dr. across from South State Park	Special Use	700 acres	Inland lake and wooded area that offers small boat launch, 5 miles of ungroomed trail for hiking and cross country skiing, bird viewing, fishing, hunting and wildlife viewing. Owned and operated by the State of Michigan.
Roscommon North Youth Soccer Association Youth Football League Fields on Pinewood off County Rd. 100	Sports Complex	> 3 acres	5 soccer & football fields owned by the C.O.O.R. ISD and operated/maintained by the Roscommon North Youth Soccer Association & Roscommon Youth Football League.
Pioneer Hill County Road 100 adjacent to C.O.O.R. ISD	Special Use	> 1 acre	Large open hill area utilized for downhill sledding and Higgins Lake Winterfest activities. Owned by C.O.O.R. ISD.
Higgins Lake Land Conservancy	Special Use	20 Acres	Large parcel of pristine land.

RESOURCE INVENTORY

The Gerrish Township Master Plan, as adopted in February 2010, serves as a guiding factor in the recognition of desirable green spaces, potential parks and recreation areas and the planned retention of such areas. Planning for green spaces and additional recreational and/or existing park facilities should incorporate both proposed land use patterns and demographics information.

GEOLOGY AND TOPOGRAPHY

The makeup of Gerrish Township's geology and topography has an impact on the development and growth of our parks and recreation sites. Development is generally discouraged in areas with excessive slopes as well as areas of low levels, such as swamp areas. The majority of the Township is generally described as level to rolling. A large portion of Gerrish Township sits on Michigan Formation, which is predominantly shale. This bedrock is then covered by drift materials.

The overall grade of the Township reflects grades of 2% or less with the exception of two distinct areas. These areas range in grade from 5% - 16% and occur in a diagonal ridge crossing the northeast and southwest corners of the Township. They are the highest levels of elevation in the Township at 1320 to 1360 feet above sea level. The lowest elevations are 1150 feet below sea level and can be found in the area where the Cut River exits Gerrish Township. (See Map 2)

VEGETATION

The makeup of Gerrish Township's vegetation is primarily upland forests and lowland woodland and wetlands. The upland forests comprises roughly 10,000 acres of the Township and is comprised of species such as aspen, birch, oak, hickory, cherry, maple and beech trees. A majority of the woodlands consist of pine such as jack, white and red. These forests are primarily state owned lands and are subject to managed harvesting. The Township's wetlands are approximately 2,500 acres and are covered with hardwoods such as ash, elm and spruce.

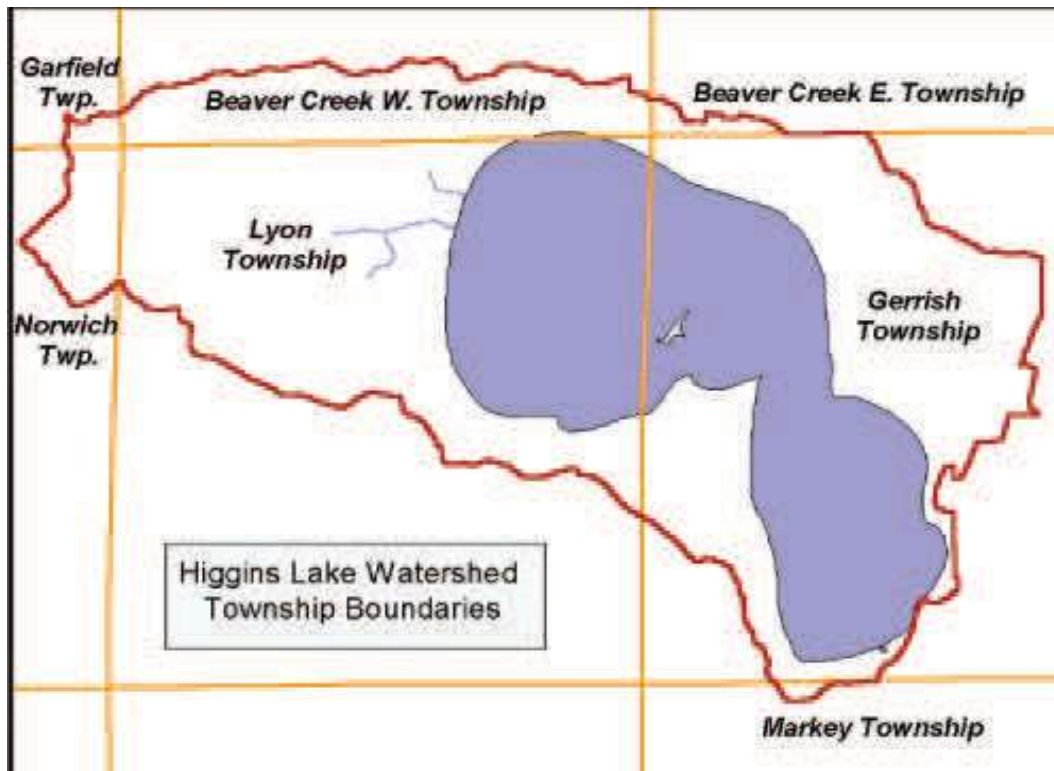

WATERS AND SOILS

The extent of surface water resources has been the most important contributing factor towards the development of the county as a major recreational area. Higgins Lake is the most dominant natural feature of our Township. It covers roughly 10,300 acres of our 23,808 acre Township and its shoreline is almost completely developed with homes and cottages. Higgins Lake drains a watershed area of approximate 22,000 acres and includes the Cut River which drains from Higgins Lake to Marl Lake and runs into Houghton Lake. Marl Lake covers 237 square acres and has a maximum water depth of 4 feet. Its shoreline consists of wooded lands owned by the State of Michigan. Gerrish Township also has two wetland areas, the Baton and Hiedeman Marshes which should be protected from development. Soils within Gerrish Township are highly permeable; the geologic and soil conditions in this area favor the storage of water and provide better than average ground water reservoirs. The soil is primarily sand with isolated pockets of clay deposits though there are pockets of muck soils throughout the southeast quarter.

WILDLIFE

Gerrish Township offers an abundance of suitable habitats for wildlife. The numerous forests, lakes and streams are a more than suitable environment for dozens of Michigan native wildlife species. Higgins Lake, the Cut River and Marl Lake host strong fish populace. They are active fishing areas and host brown trout, lake trout, northern pike, smallmouth bass, rainbow trout, rainbow smelt plus several other species of fish. The watershed area provides for numerous waterfowl such as bufflehead and golden eye ducks. Gerrish Township is also home to whitetail deer, red fox, bear, coyote and other smaller mammals. The protection of our wildlife must be considered when planning and projecting our recreation and park areas.

TRANSPORTATION

Gerrish Township offers excellent regional access as it is centrally located between two major interstates: I-75 and US-127. The Township is bordered on the east by M-18 and from the north by Federal Highway. There are six County Route roads that are considered 'primary' and are considered the most critical in providing regional access to the Township. All other public roads within Gerrish Township are considered local.

Residents and visitors of Gerrish Township rely primarily on private vehicles for transportation. Public transportation is available through the Roscommon County Transportation Authority which allows for scheduled rides countywide six days a week. Recreational vehicles such as snowmobiles and ORV's are operated on county and local roads and allow for easy access to trails, Higgins Lake and other recreation areas.

Though Gerrish Township does maintain a walking trail and portions of our County Roads are maintained for pedestrian and bicycle traffic, these areas do not clearly connect parks and recreation areas and are located on some of the busiest traffic points.

FUTURE LAND USE PATTERNS

Gerrish Township is characterized by large areas of forests, wetlands, water courses, lakes, streams and wooded areas. The preservation of such areas is vital to the availability of recreational opportunities within Gerrish Township. The Gerrish Township Master Plan was developed with the protection of natural resources and the Township's rural and resort atmosphere as core interests. The Future Land Use Strategy as outlined in the Master Plan identifies six major areas of land use patterns: Lakeshore Residential, Rural Residential/Conservation Areas, Suburban Residential Areas, Commercial Areas, Industrial Area and Commercial/Industrial Mixed Use Areas. (Map 3: Future Land Use)

Future green spaces and parks should be developed within the Rural Residential/Conservation Areas. This zoning encourages the preservation of our natural resources and recreation attributes. Suburban Residential Areas may also be utilized for recreation facilities as park areas support and enhance quality of life and improve community identity.



Planning Process

BASIS FOR ACTION

Demands for recreational opportunities increase with population growth. Though Gerrish Township's permanent population dropped slightly between the 2010 Census and the 2017 American Community Survey, the seasonal population, both weekend residents and tourists, has continued to increase. Facilities that have traditionally been able to support both permanent and fluid populations are congested and in need of improvements. Our current parks and recreational opportunities need to be reviewed and reassessed based on the changing needs of our residents and visitors.

PLANNING PROCESS

Gerrish Township, acutely aware of the value of parks and recreation areas to our community, adopted a preliminary Recreation Plan in 1995. Since the inception of the original plan, it has been reviewed, updated and readopted at regular five year intervals.

In April, 2011, the first Parks & Recreation Advisory Committee was appointed to begin work on updating and improving the prior five year recreational plan. Now with renewed members, has continued to meet to address the needs of our citizens. The Parks & Recreation Advisory Committee met a total of six times, held one public input meeting, conducted a public input survey, addressed several government classes at the high school for youth input along with having several individual conversations and correspondences prior to formal presentation to the public. The Gerrish Township Master Plan (LANDPLAN, 2011) was also utilized as reference and guidelines in formalizing the Recreational Plan.

COMPARISON TO RECREATION STANDARDS

The National Recreation and Park Association (NRPA), a national, not-for-profit organization dedicated to advancing park, recreation, and conservation efforts, developed recommended recreation standards for common facilities and activities as

well as open space management. Township owned recreational facilities were reviewed against the NRPA standards and weighed against public input. Gerrish Township currently owns approximately 32 acres for open spaces and recreational activities. This, coupled with the additional 5,000 acres for State owned lands, places Gerrish Township well over the NRPA standards of 10 acres per 1,000 population recommended green space even with consideration for the nearly 30,000 seasonal visitors to our area.

Comparisons between the NRPA suggested facility development standards and current recreational facilities within Gerrish Township found several deficiencies. Of the four active recreation areas within the Township, two areas were established and completed prior to the adoption of the NRPA recommendations. Both the Gerrish Township Municipal Park and the Gerrish Township Park are lacking in both size and space requirements for a majority of the recreational opportunities offered. The East Walking Trail is fairly compliant with the criteria needed for a pedestrian nature trails though its width and grading desire improvement. The Community Park Marina is in the developmental stages for recreational facilities, does not currently offer recreational opportunities as reviewed by the National Recreation and Park Association. Future projects will be done with consideration to the standards for space, size and design standards. However, the NRPA standards were utilized as guidelines, not as absolutes, and consideration has been given to the community characteristics and needs as well.

PRESERVATION AND IMPROVEMENT

In accordance with the Gerrish Township Master Plan, of foremost importance to future planning of our parks and recreation is the protection of the Township's rural and resort atmosphere through protection of our natural resources including Higgins Lake, state forest lands, abundant woodlands and wetland areas. The preservation and protection of these areas ensures that the overall peaceful, rural characteristic of our community is maintained. The Recreational Committee utilized the areas defined by the Future Land Use Map (Map 3) as Rural Residential/Conservation Areas in planning for preservation of green spaces on open lands.

While the current recreational spaces within Gerrish Township are more than adequate for both our permanent and transient residents, the structures and facilities that are offered at each location are lacking in ADA accessibility and construction and safety standards. The buildings and grounds of our current parks and recreational areas are in need of reorganization and revitalization to allow for better usage and utilization. Safety standards for playgrounds are below standards and should be improved within the course of the next five years. Growth and maintenance efforts for existing areas should be conducted with the Township's dedication to retaining a rural, 'up north' atmosphere.



Public Input Process

PUBLIC INPUT PROCESS

The Gerrish Township Parks & Recreation Advisory Committee utilized three major methods of obtaining resident and visitor input for parks and recreation; public meetings, presentation to high school government classes and a comprehensive survey. A recreational needs survey was distributed in November of 2019. Several means were utilized to ensure that all residents were given an opportunity to participate. The survey was made available in both an online fillable form and hardcopy and was available via a website link, emailed to community organizations and resident associations. A copy of the survey can be found in Appendix A. A total of 265 surveys were completed and submitted and the data, as seen in Appendix B, showed overwhelming support for increased walking, biking and nature areas as well as a need to continue to market and improve current facilities before creating additional park areas.

A public input and discussion hearing was held on December 5, 2019. Notices were published in local papers and on the Gerrish Township website.

Approximately 25 residents attended and two residents submitted opinions and suggestions via email. Minutes from the meeting are available in Appendix C.

The Parks & Recreation Advisory Committee also held six public meetings to review and discuss the specific needs of our community in relation to parks and recreation. Each committee member represents a different population segment, demographic or interest group and was able to bring unique contributions to the planning process.

The Township published notification of a Public Hearing on December 5, 2019 and received comments from residents on January 9, 2020. The notification can be viewed in Appendix D. Minutes from the Public Hearing are listed in the Supplemental Documents.

GOALS AND OBJECTIVES

The Parks & Recreation Advisory Committee utilized the following factors for analysis and development of goals and objectives: requests and needs of citizens, Board of Trustee goals and input, future land use, NPRA Park Metrics and budgetary constraints. Careful review of the above factors led to the development of the five major goals to be accomplished within our five year recreation plan. Those goals are identified on the next page.

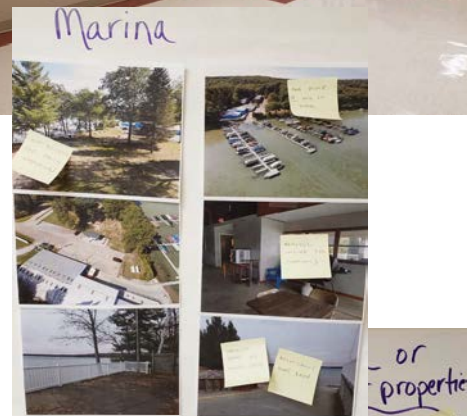

12/18/2019 draft	Gerrish Township	Parks and Recreation 5 yr plan	Goals and Objectives			
Goal 1: Enhance existing recreation assets to promote usage to their fullest extent.						
Objectives	Goal 1 Objective 1	Goal 1 Objective 2	Goal 1 Objective 3	Goal 1 Objective 4	Goal 1 Objective 5	Goal 1 Objective 6
	Develop a site master plan for each of the 3 township parks to plan for future enhancements.	Add amenities to improve the recreation options at each existing township-owned park.	Enhance water-based recreation assets to best utilize our natural features.	Develop a list of amenities and potential programs. Seek partners to offer those programs.	Increase park and rec budget through the sale of unutilized township-owned property and forestry revenues.	Provide and support year round recreation activities including indoor options.
Goal 2: Marketing/Promotions, Events						
Objectives	Goal 2 Objective 1	Goal 2 Objective 2	Goal 2 Objective 3	Goal 2 Objective 4	Goal 2 Objective 5	
	Inform township property-owners regularly of updates in the PR dept and make information available to visitors about amenities and events	Add the volunteer positions of township historians to the P-R Committee who would be willing to provide pictures of events and happenings for use by the twp	Partner with more local groups and industry-focused groups to host more events	Create welcome packets and promotional brochures for new residents and businesses.	Create a marketing campaign using a multi-media approach including web-based, social media, print media and partner agencies/	
Goal 3: Promote healthier lifestyles through improved access to recreation amenities						
Objectives	Goal 3 Objective 1	Goal 3 Objective 2	Goal 3 Objective 3	Goal 3 Objective 4	Goal 3 Objective 5	
	Collaborate with partners in healthy programs such as the Higgins Trailway initiative	Support multi-use trail systems and connect to trails when possible	Provide and promote more recreation activities and events for all ages and abilities.	Promote and encourage active and passive use of the township-owned parks.	Build relationships and community through involvement in the parks and recreation available to Gerrish Township citizens.	
Goal 4: Maintenance, safety and security						
Objectives	Goal 4 Objective 1	Goal 4 Objective 2	Goal 4 Objective 3	Goal 4 Objective 4	Goal 4 Objective 5	
	Develop maintenance and cleaning standards	Improve safety and security	Develop a P-R department who manages their staff and budget	Develop an asset management plan including forest management for longrange planning.	Support the maintenance and safety by providing enough budgetary support in staff and equipment.	
Goal 5: Promote recreation for economic development opportunities						
Objectives	Goal 5 Objective 1	Goal 5 Objective 2	Goal 5 Objective 3			
	Provide amenities to support recreation users to offer the best experience for township park users, which drives the local economy.	Actively engage the local employers as a business enhancement and workforce attraction method based on a high quality of life in Gerrish Township.	Increase our investment in the township parks based on growth in taxable values, which will increase the investment into the region and property values based on quality of life.			

Action Items

The Action Program was developed based largely on public input as received via public meetings, parks and recreation need surveys and also based on the current economic conditions of the Township. It is intended to act as strategic actions that will be taken over the next five year period. These actions are intended to assist Gerrish Township in achieving the goals and objectives as outlined in the Parks and Recreational Plan.

Action Item Project	Location	Priority	Estimated Cost	Expected Completion	Potential Funding Sources	Goal/Objective
Site master plans developed for each park	All Parks	High	\$60,000	2020	Budgeted funds, EPA planning grant	1/1
Increase merchandise sales to support park improvements	All Parks	High	0	2020	-	1/5
Create/distribute marketing materials	All Parks	High	500	2020	Budgeted funds	2/1-4
Improve signage and painted markings for van accessible parking	All Parks	High	\$1,000	2020	Budgeted Funds	3/3
SOP and checklist for cleaning	All Parks	High	\$500	2020	Budgeted Funds	4/1
SOP and checklist for maintenance including preventive maintenance and inspections schedules	All Parks	High	\$1,000	2020	Budgeted Funds	4/1
Improve pickleball and market them	Township Park	High	\$2,000	2020	Budgeted funds	4/5
Install a mobimat	Carlos Park	Medium	\$6,000	2020	Reeves Grant, Rotary, Community Foundation	3/3
Indoor Activities for winter	Marina	High	1000	2021	Budgeted funds, partnerships	1/6
Seek partners to host recreation programs at township parks	All Parks	High	-	2021	Partner agencies	2/3
Designated dog areas with Clean-up bags	Township Park	High	\$6,000	2021	Crowdfunding, merchandise sales, DNR grants	3/4
Forest Management Plan	All Parks	High	\$3,000	2020	Budgeted Funds	4/4
Ice rink	Marina	Medium	5000	2021	Budgeted Funds, Crowdfunding	3/3
Add food trucks & vendor policy	Marina	Medium	\$0	2021	-	4/1
Parking Lot Striping	Marina	Medium	3000	2021	Budgeted funds	4/2
Install toddler play structure & zipline	Township Park	High	\$25,000	2021	Gametime Grant, crowdfunding	1/2
Add Disc Golf	Township Park	Low	\$30,000	2022	Crowdfunding	1/2
Install ADA picnic tables	All Parks	Medium	\$10,000	2022	Budgeted funds and local scout troop	3/3
Add benches	Township Park	Medium	\$1,500	2022	Budgeted funds	3/4
Resurface basketball courts, stripe, add new nets	Township Park	Medium	\$1,000	2022	Budgeted Funds	4/6
Install recycle bins at each park	All Parks	High	\$3,000	2023	Keep America Beautiful Grant	4/6
Marina waterfront improvements improve ramp, add walkway and kayak launch	Marina	Low	\$150,000	2023	LWCF, DNR grants	4/1
Renovate marina building interior	Marina	Medium	100000	2023	DNR Grant, LWCF, Gerstacker	1/6
Add 1 pavilion, outdoor fireplace, benches, restroom/changing rooms	Marina	Medium	\$150,000	2023	Home Depot Grant, DNR Passport funds	3/4
Install cameras in high risk areas	Carlos/Marina	Low	\$7,000	2024	Par Plan Grant	4/2
Install fence for tennis courts and add 1 wall for 1-player tennis	Township Park	Medium	\$5,000	2024	Budgeted Funds	1/2
Parks-Recreation Committee Review the Action Items semi-annually to plan and assess each year's selected items	All Parks	High	0	2020 -2025	Budgeted funds	1/1
Annually select township historian(s)	All Parks	High	-	2020 -2025	-	2/2
Add restrooms and picnic area	Township Park	Medium	\$100,000	2022	Dnr Grant	1/2

MAPS:

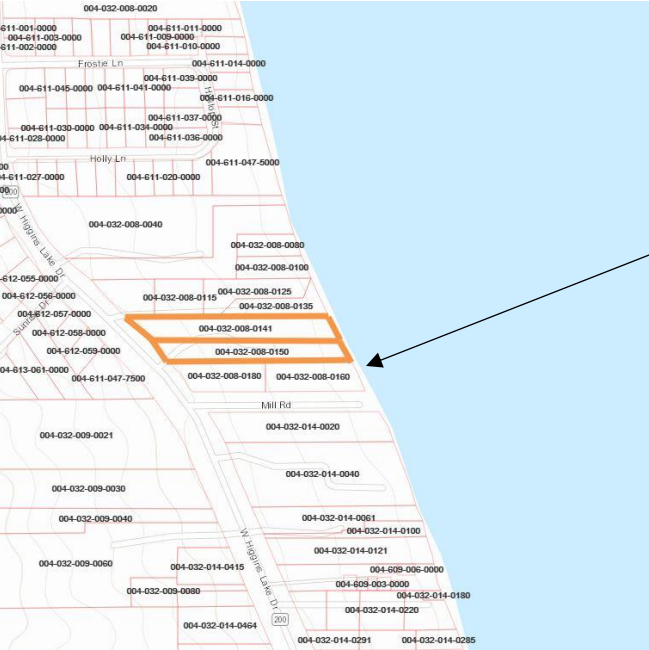

Map A:
Marina Park

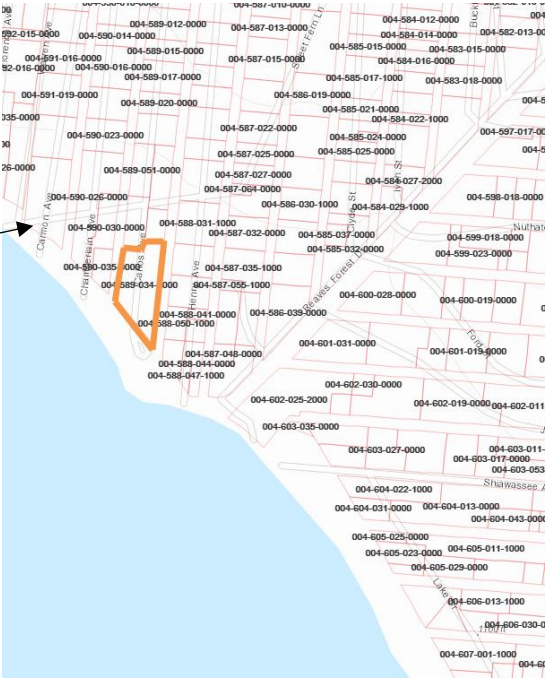
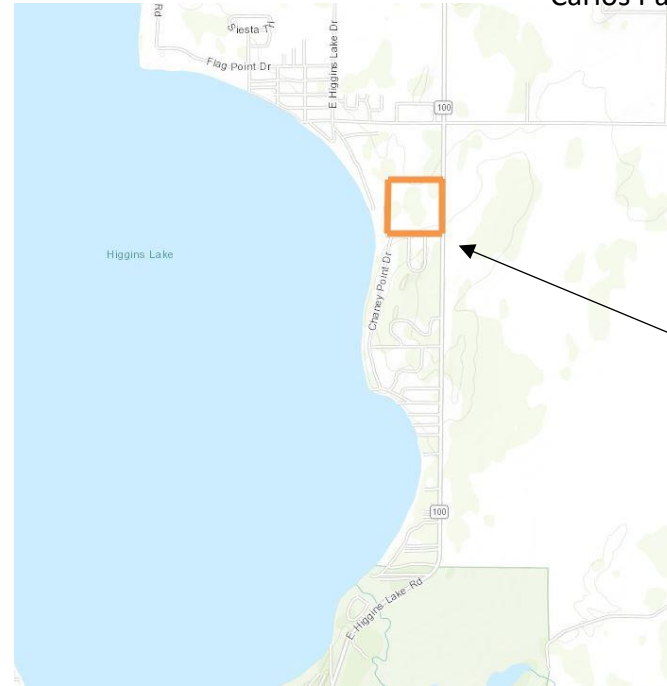

Map C:
Township Park

SURVEY

Question 1

Q1 Please indicate which parks or recreation areas you and your family have used or been to:

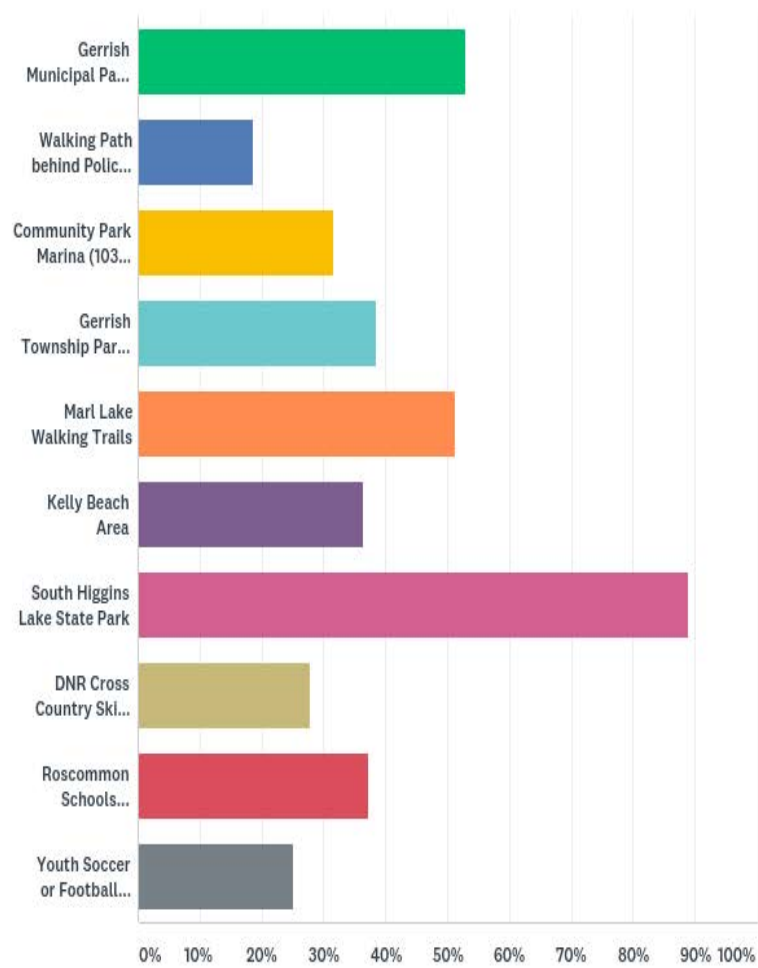

Q2 What types of outdoor activities do you enjoy? (Check all that apply)

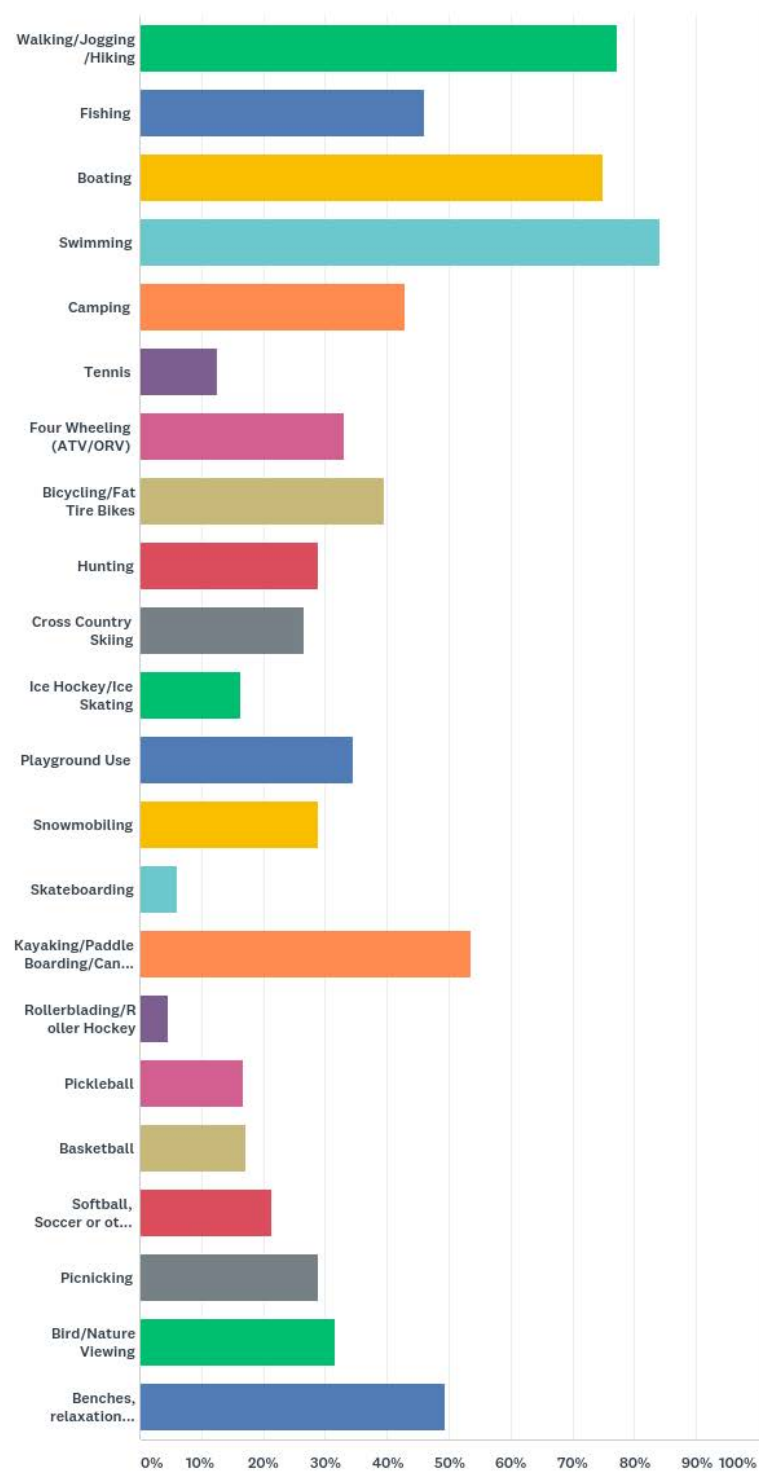

SURVEY COMMENTS SUMMARY QUESTION 3: Q3-WHAT AMENITIES WOULD YOU LIKE TO SEE THE TOWNSHIP FOCUS ON IMPROVING AT TOWNSHIP PARKS AND RECREATION AREAS?

<u>Marina Park (Pink)</u>	<u>Trails (Neon Yellow)</u>	<u>Township Park (Green)</u>	<u>Carlos Park (Orange)</u>	<u>Swimming and beaches (Magenta)</u>	<u>Other amenities, properties (Blue)</u>	<u>Maintenance and Marketing (Purple)</u>	<u>Not location specific (Dark Blue)</u>
3-Indoor Ice Rink	153-Walking/biking trails	113-Restrooms	55-Beach Volleyball	199-More beach access	94-Dog Park	12-Maintenance and cleanliness	103-More picnic tables overall
3-More boat slips	14-Bicycle Trails	77-Interactive Nature Park	19-Improved playground	101-Water trails/Kayak Launch	4-Dog clean-up stations	5-Marketing/Promotion	99-Ziplines, Ropes and Challenge Course
4-Fireplace	3-Better trail signage/maps/marketing	68-Outdoor workout equipment	5-Pavilion for group picnics	3-Better maintained beach	4-Kelly Beach Parking	5-More events and activities	87-More pavilions
2-Food Concessions	2-ADA Trails	65-Splash pad	5-Improved restrooms	2-Reduce weeds	2-Kelly Beach Bathrooms	4-Improvements at non-township assets	59-Better playgrounds overall, more equipment
2- Fuel tanks	2-Access to ORV ATV Snowmobile Trails	56-Pickleball	5-Benches	2-More boat launches	1-Land Conservancy efforts	3-Enforce laws	56-Disc Golf
1-Resident preference first	1-Trail Lighting	40-Improve basketball courts	5-ADA beach mat	1-No smoking beaches	1-Kayak launches at all lake access	2-Smoking ban in parks	47-Ice Rink in general
1-Playground upgrades	1-Sidewalks	28-Football/Soccer	4-Upgraded/more picnic tables	1-More water access	1-Edible garden	2-Overall safety	28-Horeshoe pit
1-Picnic Tables	1-Nature trails	20-Improved Tennis Courts	4-More parking	1-Lake pollution prevention	1-ADA mat at all parks	2-Environmental stewardship	25-Skatepark
1-Pavilion	1-Dog Friendly Trails	19-Improve softball diamond	3-Extend Swimming area	1-In-water rope challenge course		1-Improved parking	2-Recycling containers overall
1-Kayak Launch	1-Clean up near compost area to make trail nicer	5-Ropes/Challenge course	2-Amenities for toddlers	1-Concessions Food		1-Dedicated opportunities for township residents	2-Improved fisheries/fish stocking
1-Interior renovation	1-Boardwalk on Grosbeck Trail	5-Improve playground	1-Trash/Recycling containers	1-Clean lake maintenance			2-Food
1-Improved ramp	1-Benches along trail	3-Teen centered amenities	1-Teen spaces	1-A second marina			2-Amphitheater stage
1-General marina improvements	1-Grills	2-More for kids to do	1-Shuffleboard, bocceball, Gaga ball				1-More, open parkland
1-Cheaper Gas		2-benches	1-Lighting				1-More grills overall
1-Benches		1-Wall for single player tennis	1-Improved maintenance				1-Lighting
1-Grills		1-Self-guided nature trail	1-Grills				1-ATV Park
1-Bathrooms		1-More adult amenities	1-More sand for Carlos park beach				
1-Walkway to water		1-Grill					
1-Swim Area		1-Ice arena					
		1-Better lighting			Individual Survey Comments/quantity of the same comment		

Q4 What facilities, equipment or amenities would you like to see added to the township parks?

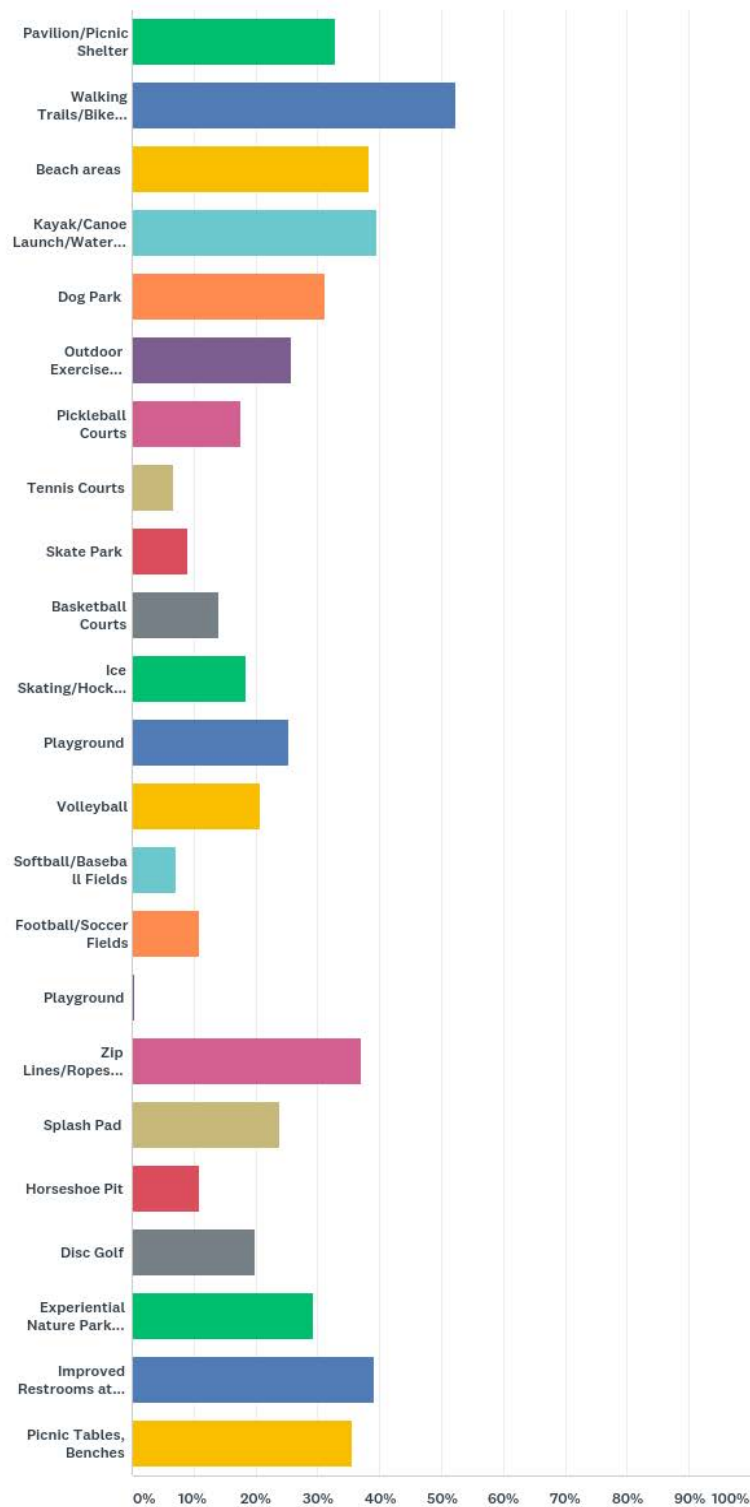

Question 5

Q5 Ages of your household members?

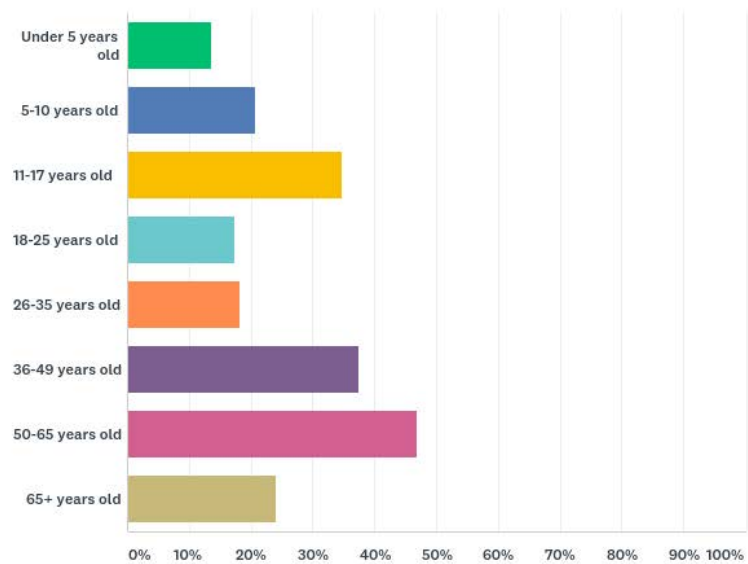

Question 6

Q6 What township recreation offerings are most important to you and your family? (RANK in order of importance: 1=highest, 10=lowest)

Answered: 251 Skipped: 14

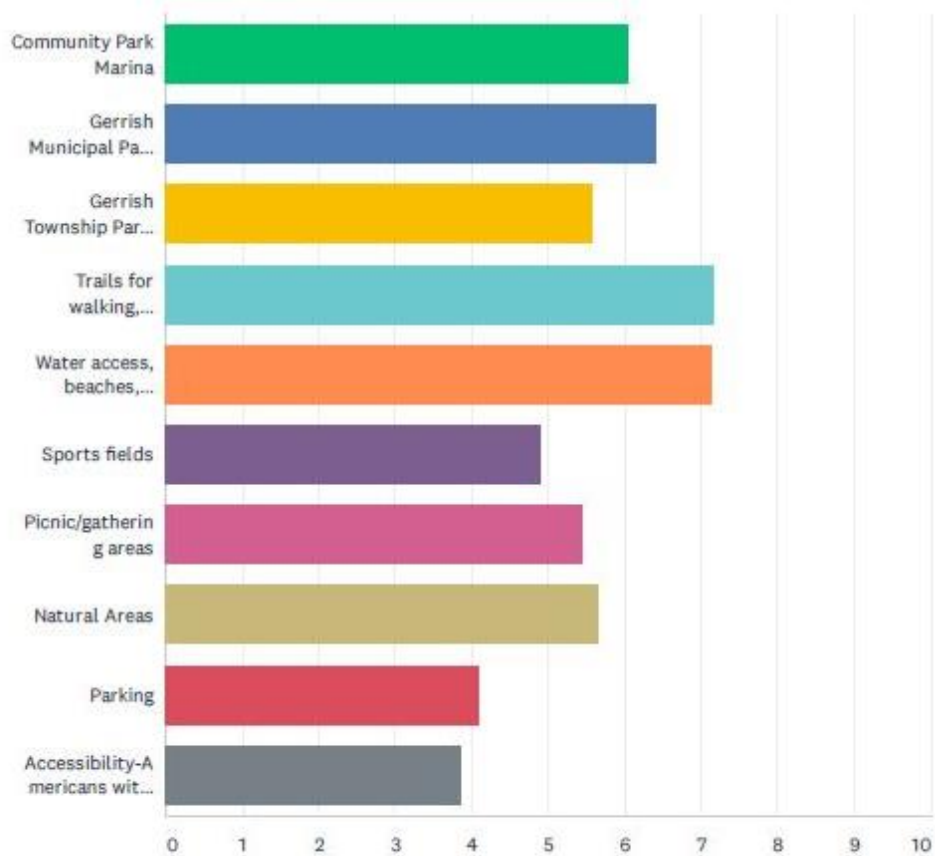

Q7 How would you rate the following at the township's parks?

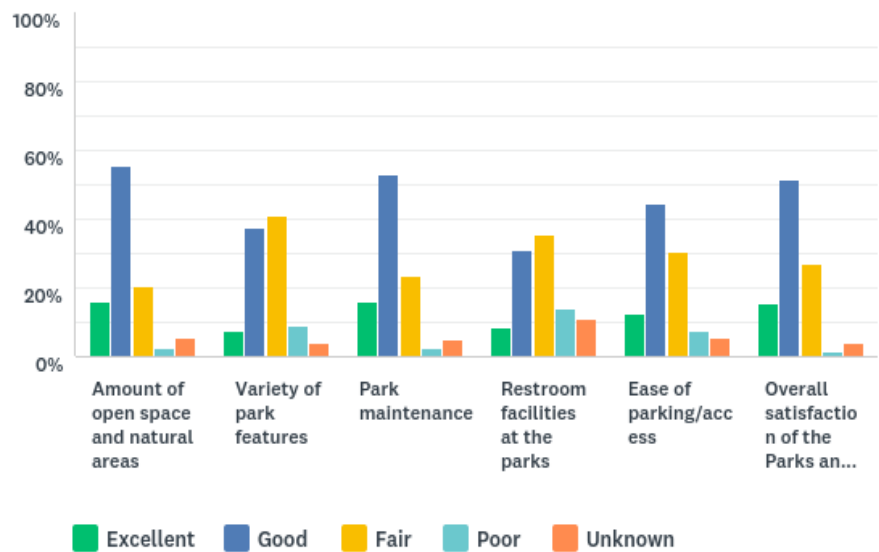

Q9 What priority should the township put on the parks and recreation facilities in terms of budget and improvements?

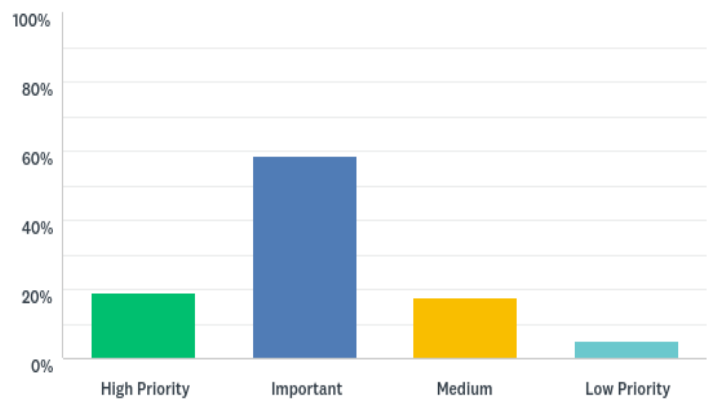

Q8 What improvements would you like to see made to the existing township parks and recreation areas in programs, amenities or equipment?



Question 10

Q10 Please choose one of the following:

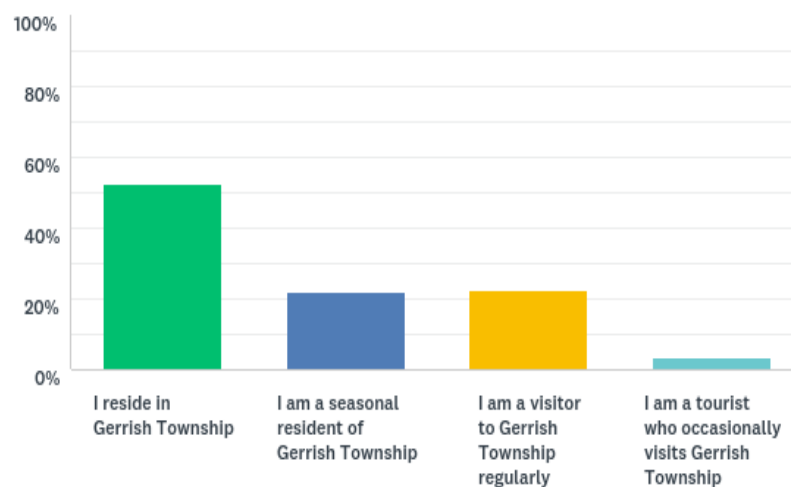

SUPPLEMENTAL INFORMATION:

**GERRISH TOWNSHIP
NOTICE OF PUBLIC HEARING**

Gerrish Township has been working on an updated 5-year Parks and Recreation Plan. A working draft of the 2020-2025 Parks and Recreation Plan is available for review and comment until 4:00pm January 8, 2020 at gerrishtownship.org or at the Municipal Building. The public hearing to discuss the proposed 2020-2025 Gerrish Township 5-year Parks and Recreation Plan draft will be held at the Gerrish Township Municipal Center at 8:30 a.m. on Thursday, January 9, 2020 at the following location: Gerrish Township Municipal Center, 2997 East Higgins Lake Drive, Roscommon, Michigan 48653.

Any questions and comments prior to public hearing should be directed to the Gerrish Township Treasurer at (989)821-9313. All written comments received and oral comments made will be entered into the public hearing record.

Kathleen Patchin, Clerk

**GERRISH TOWNSHIP
Public Hearing
Parks and Recreation 5 Year Plan
2020-2025**

January 9, 2020

Call to Order: 8:30am

Pledge of Allegiance

Roll Call: Supervisor Udy
Clerk Patchin
Treasurer Tulgetske
Trustee Link
Trustee Lippert

Additions and/or changes to the Agenda:

SPECIAL ORDER OF BUSINESS:

Public Hearing to solicit comments on the Gerrish Township Parks and Recreation 2020-2025 5-year plan

Public Comments/Questions:

Board Follow up to questions/comments

Exit public hearing

Announcements

Adjournment

Gerrish Township Public Hearing

Thursday January 9, 2020

8:30am

Parks and Rec 5 Year Plan

	Name	Address
1	Tony Ide	5840 Ellixson Ct.
2	Jim Fisher	11841 Ivy RD
3	Dave Hall	116 Huntington DR
4	Wall	10581 Field Eastridge
5	Kelly Koppke	2715 Southwest Dr.
6	Mary Jo O'Day	122 Charlene Dr.
7	Sally Vonheid	127 Forest Trail
8	Mike Turkey	111 Sunrise
9	Brendan Rodgers	330 Ivy Dr
10	Philip Czech	148 FLAG POINT
11	BRIAN Hill	114 Argus Ct.
12	Terry Newton	1660 W. Maplehurst
13		
14		
15		
16		
17		
18		
19		
20		

GERRISH TOWNSHIP BOARD
SPECIAL MEETING
January 9, 2020

Special meeting convened at 8:30am. Present: Supervisor Udy, Clerk Patchin, Treasurer Tulgetske, Trustee Lippert and Trustee Link. Also present: Lisa Leedy from Alliance from Economic Success and 12 citizens.

Motion by Udy, supported by Lippert: CARRIED
that the Board approve the Agenda as presented.

Motion by Patchin, supported by Tulgetske: CARRIED
that the Board enter the Public Hearing to solicit comments on the Gerrish Township Parks and Recreation 2020-2025 Recreation Plan.

Public Comments and Questions:

Comment: It mentions a dock at Kelly Beach and there is no dock located there.

Response: The Kelly beach information can be updated to reflect accurate size and accommodations. Comment: Budget figures are concerning with expenses being higher than revenues. Response: The revenue figures in the budget don't reflect the equity accounts in place for parks and recreations. We will review to get a more accurate reflection.

Motion by Patchin, supported by Udy: CARRIED
that the Board exit the Public Hearing and re-enter the Special Meeting.

Public Comment: None

Motion by Lippert, supported by Link: CARRIED
that the Board adjourn.

Meeting adjourned at 9:01am.



Kathleen Patchin, Clerk

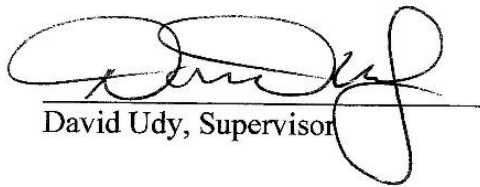

David Udy, Supervisor

____ Approval

January 24, 2020

**RESOLUTION OF SUPPORT TO ADOPT THE GERRISH TOWNSHIP RECREATION
PLAN 2020-2024**

Whereas, a current plan is beneficial for developing and maintaining our recreation resources in the Township and a current recreation plan is required to qualify for State and Federal funding; and

Whereas, an updated Recreation Plan has been prepared by the Park and Recreation Committee with the involvement of Gerrish Township citizens; and

Whereas, this updated plan will replace the 2011-2015 Recreation Plan.

Whereas, this plan was recommended for adoption by the Gerrish Township Parks and Recreation Committee at their December 9, 2019 meeting; and

Now Therefore Be It Resolved, that the Gerrish Township Board adopts the 2020-2024 Recreation Plan for Gerrish Township become effective on February 1, 2020.

The foregoing resolution has been offered by Township Board Member Patchin, supported by Board Member Tulgetske. The roll call is as follows:

Upon roll call vote, the following voted:

Aye: Link, Lippert, Tulgetske, Patchin

Nay: None

Absent: Udy

I, Kathleen Patchin, the duly elected and acting Clerk of Gerrish Township, hereby certify that the foregoing resolution was adopted by the township board of said township at the special meeting of said board held on Friday, January 24, 2020, at which meeting a quorum was present by a roll call vote of said members as hereinbefore set forth; that said resolution was ordered to take immediate effect.

THE SUPERVISOR DECLARED THE RESOLUTION ADOPTED.

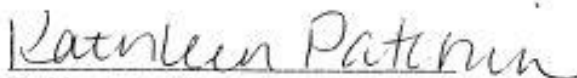

Kathleen Patchin
Township Clerk